



# Hand Drill

## Instructions for use

V3 June 2025

## Important Information

Please read before use

### Indications:

Delta Hand Drill is indicated when drilling is required in conjunction with a suitable drill bit (not supplied).

### Contraindications:

This device is not designed, sold, or intended for any use except as indicated.

### Complications:

Drill bit may become loose in the Drill Chuck. Please ensure chuck is fully tightened before use.

### Precautions:

To prevent slippage of drill bit, slowly rotate until Drill bit is fully engaged.

### Description:

Delta Hand Drill D-500-S.

### Sterility:

The Delta Hand Drill is intended for single use only, do not re-sterilise.

#### Manufacturer



Name: Shenzhen Ruixie Industrial Co. Ltd.  
Address: East Side, 1/F., No.1 Building, Hengguan Industry Zone, Xinqiao Shajing, Baoan, Shenzhen, China

#### European Representative



Name: MedPath GmbH  
Address: Mies-van-der-Rohe Strabe 8, Munich, 80807 DE



Hand Drill  
Instructions for use



+44 (0)1782 637009



sales@deltasurgical.co.uk

# Caution

Please read all instructions before use

**This product is for single use only, do not re-use.**

- Do not use if inner packaging or product is damaged
- Do not use this product beyond expiration date
- Only use approved drill bits\*
- The product is a medical device. Users must ensure they have the relevant expertise and clinical training before use
- Read & understand the instructions before using this disposable hand drill\*
- Before each use, operate the device by rotating the handle and drill chuck clockwise and anticlockwise respectively and inspect each component for damage. DO NOT use any component if damage is detected\*
- Do not apply excessive pressure, allow Drill bit to rotate freely\*
- The appropriate rotating speed is important for the surgical operation. Please rotate the handle carefully and slowly
- After installing the drill bit, inspect and ensure that it is secured before operating the hand drill
- Dispose of the used hand drill according to the laws and regulations of the medical waste disposal method. Failure to comply may result in environmental pollution and human injury

**\*Failure to comply may result in patient and/or health care staff injury**

Please read both sides of these instructions

# Instructions for Use

- 1** Perform all procedures in accordance with established clinical techniques and protocols
- 2** Handle Securing - Unfold the handle arm and lock it into the open position. Verify that the handle is securely fastened (refer to Figure A).
- 3** Drill Bit Selection and Installation - Select the appropriate drill bit for the procedure and insert it into the chuck as depicted in Figure B.

**NOTE:** To adjust the chuck wider for the drill bit diameter, rotate the chuck counter clockwise.

- 4** Securing the Drill Bit - Tighten the drill bit using the provided chuck key to ensure it is securely in place. Apply even pressure by rotating the chuck key clockwise at all three designated points, ensuring accurate alignment (refer to Figure C).
- 5** Verification of Drill Alignment - Rotate the handle both clockwise and counter clockwise to confirm that the drill bit is aligned properly and rotates without deviation. If any misalignment is detected, loosen the chuck and re-secure the drill bit by following the previous steps.

**Note:** To remove the drill bit, repeat the above procedure, rotating the chuck counter clockwise.

- 6** Procedure setup Complete - the Drill is now properly set up and ready for the procedure.

Please read both sides of these instructions

# Additional Information

Contraindiction: N/A. Shelf Life: See product labelling.

Storage & Transportation: Ensure the product is stored in a clean, dry environment and out of direct sunlight.

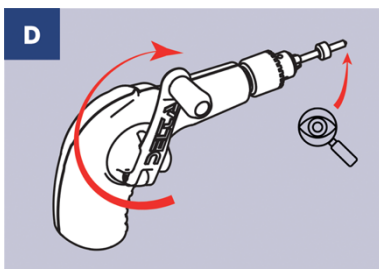
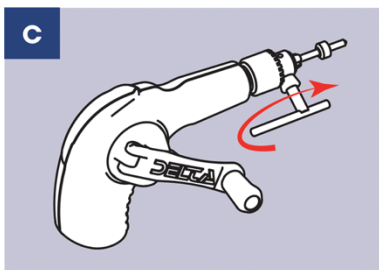
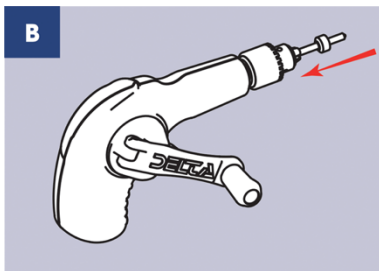
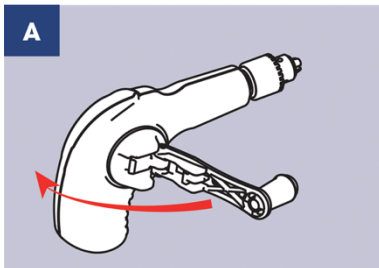

## Symbol Guide



Manufacturer



Date of manufacture



Distributor



Use by



Do not reuse



Do not use if package is damaged



Keep away from sunlight



Keep dry



Batch code



Reorder number



Authorized Representative in the European Community



CE mark



Indicates the item is a medical device



Indicates a carrier that contains unique device identifier



Caution



Indicates a medical device that has not been subjected to a sterilization process



Consult instructions for use